

Contents

Vehicle Details.....	2
Kit Details	2
Recommended Compressors	3
Compressor Kit Configurations	3
Parts View	4
Parts List	4
Foreword	5
Standard Torque Values	5
Pre Installation	6
Mount Bracket Installation	6
Drive Belt Installation.....	7
Finish	8

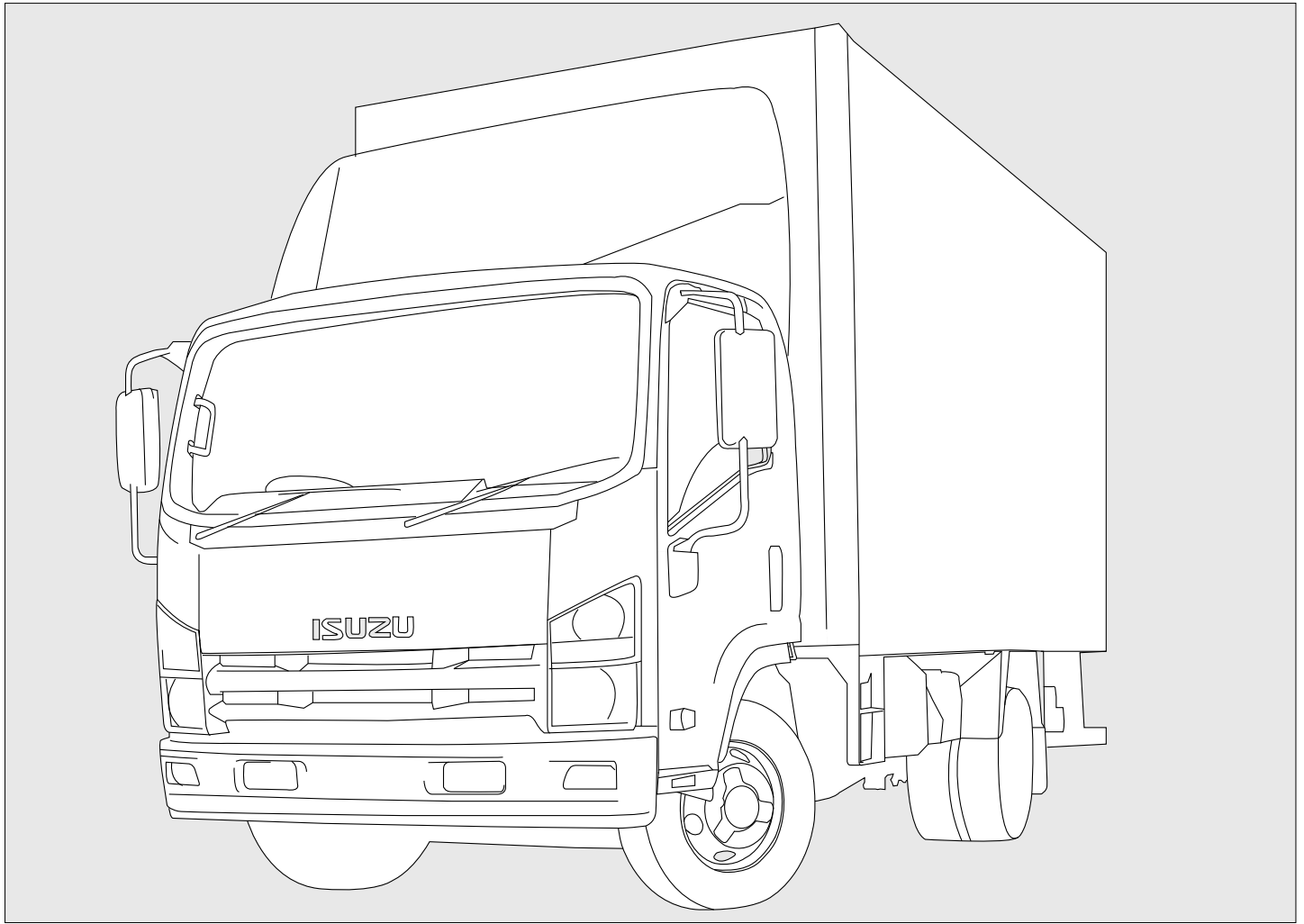

VEHICLE DETAILS

Manufacturer	Isuzu
Model	EURBAN N75.150
Engine CC	3.0 Litre
Engine Details	Euro 6 (VI) 4JJ1TS 110kW / 150PS
Year	04.14>
Chassis Nos.	N/A
LHD	YES
RHD	YES
PAS	YES
A/C	NO
Voltage	24v

KIT DETAILS

Kit Part Number	0500.7462
Description	Speed Reduction Kit
Compressor RPM 3007 @ Max engine power output	
Fitting Time	45 Minutes
Suction Fitting	90°
Discharge Fitting	90°
Belt Type	13A 1300
Belt Part Number	0800.0361
Note	Compatible with Easyshift

RECOMMENDED COMPRESSORS

SELTEC	TM-13 HS	TM15-HS	TM16-HS
Comp No.	0381.0722	0381.0122	0381.0222
Seltec No.	435-54071	435-55015	435-56015
Mounting	Ear	Ear	Ear
Rotor	2A	2A	2A
GL	39.6mm	39.6mm	39.6mm
Armature	3E	3E	3E
Diameter	135	135	135
Voltage	24	24	24
Orientation	V	V	V
Fitting	3/4 x 7/8	3/4 x 7/8	3/4 x 7/8
Manifold	Bolt	Bolt	Bolt

SANDEN	SD5H09	SD5H14	SD7H15
Comp No.	-	-	-
Sanden No.	-	-	-
Mounting	-	-	-
Rotor	-	-	-
GL	-	-	-
Armature	-	-	-
Diameter	-	-	-
Voltage	-	-	-
Orientation	-	-	-
Fitting	-	-	-

QUE	QP13-HD	QP15-HD	QP16-HD
Comp No.	0391.0722	0391.0122	0391.0222
Que No.	QP13-1234	QP15-1153	QP16-1181
Mounting	Ear	Ear	Ear
Rotor	2A	2A	2A
GL	39.6mm	39.6mm	39.6mm
Armature	3E	3E	3E
Diameter	135	135	135
Voltage	24	24	24
Orientation	V	V	V
Fitting	3/4 x 7/8	3/4 x 7/8	3/4 x 7/8
Manifold	Bolt	Bolt	Bolt

Notes

--

COMPRESSOR KIT CONFIGURATIONS

PART NUMBER	COMPRESSOR KIT PART NOS						DESCRIPTION	QTY.
	0513.7462	0515.7462	0516.7462	0593.7462	0595.7462	0596.7462		
0381.0722	●						TM13 Ear Mount 2A 3E 135 24V V 3/4 x 7/8 Bolt	1
0381.0122		●					TM15 Ear Mount 2A 3E 135 24V V 3/4 x 7/8 Bolt	1
0381.0222			●				TM16 Ear Mount 2A 3E 135 24V V 3/4 x 7/8 Bolt	1
0391.0722				●			QP13 Ear Mount 2A 3E 135 24V V 3/4 x 7/8 Bolt	1
0391.0122					●		QP15 Ear Mount 2A 3E 135 24V V 3/4 x 7/8 Bolt	1
0391.0222						●	QP16 Ear Mount 2A 3E 135 24V V 3/4 x 7/8 Bolt	1

● = Additional parts to standard kits.

PARTS VIEW

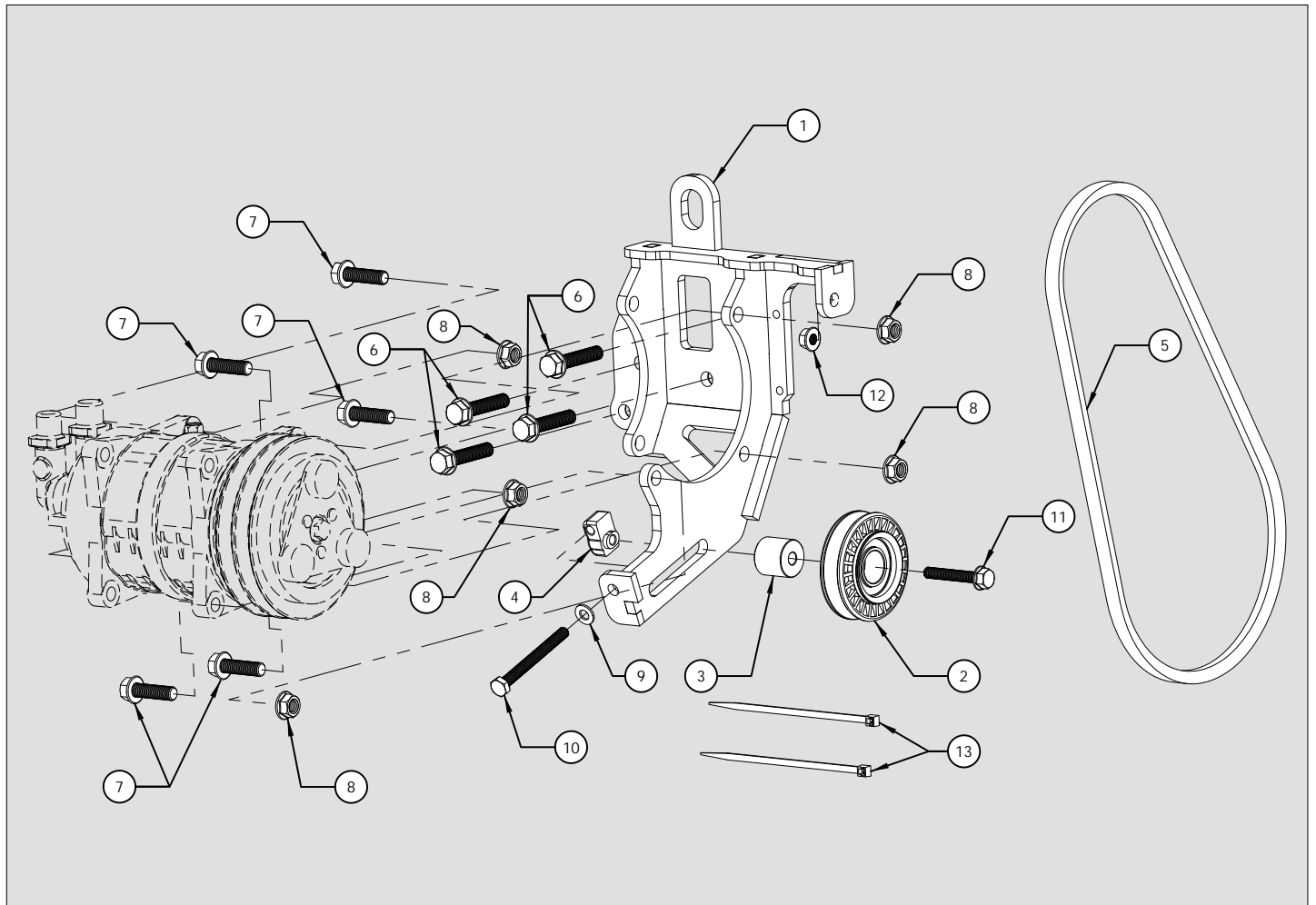

ITEM	PART NO.	DESCRIPTION	QTY.	COMMENTS
1	0440.5431	Compressor Mount Bracket	1	-
2	1700.5171	Idle Pulley A Groove 80mm	1	-
3	2803.5841	Spacer - OD 28 x ID 9 x L 25	1	-
4	1703.5003	Idle Pulley Adjuster	1	-
5	0800.0361	Drive Belt - A Section 13A 1300	1	-
6	2705.0341	Hex flange bolt Durlok - M10 x 50 : 1.50 - 12.9	4	-
7	2705.0241	Hex flange bolt Durlok - M10 x 35 : 1.50 - 12.9	5	-
8	2735.0071	Durlok Hexagon Flange Nut - M10 : 1.50	5	-
9	2808.0011	Washer M8 Flat DIN 125 - A 8.4	1	-
10	2719.0081	Hex Set Screw - M8 X 80 : 1.25 - 8.8	1	-
11	2704.0101	Hex flange bolt - M8 x 50 : 1.25 - 10.9	1	-
12	2734.0021	Durlok Hexagon Flange Nut - M8 : 1.25	1	-
13	2763.0051	Cable Tie 4.8 x 370 - Black	2	-

FOREWORD

- The purpose of this manual is to facilitate the installation of a direct drive compressor. The information given is merely instructive, should any complications arise contact the Technical department. The manufacturer's warranty does not cover any problems caused by defective installation or alterations made unless authorised. The manufacturer shall not be responsible for any injury, damage or loss caused directly or indirectly as a result of using this manual or the information contained within it.

1 SAFETY MEASURES:

Before fitting the Compressor adapter drive kit, ensure the following for damage:

- Inner and outer trim and body work
- Engine idle pace
- Check all the vehicle functions

Check list:

- Ensure that the right kit has been selected
- Before installing, check that all the correct pieces are present; also ensure that there are no missing or broken pieces
- When fitting, make sure the vehicle is properly protected against damage.

Installation apparatus

- Calibrated torque wrench
- Hand service tools
- Protective covers and shields

2 PRECAUTIONS

- Detach the battery negative lead.
- Torque all bolts where stated using a calibrated torque wrench.
- Take extreme care with moving parts.
- Remove the vehicles ignition key and keep it with you.
- Wear safeguards to make sure that liquid refrigerant never touches your skin





Caution: Measures must be followed accurately to steer clear of the possibility of damage to individuals

Warning: This calls awareness to actions which must be pursued to avoid damage to the components.

NB: This calls awareness to make the job easier or gives useful information.







STANDARD FASTENER TORQUE VALUES

- In the absence of specific torque values detailed in this fitting instruction manual, the following chart can be used as a guide to the maximum safe torque for specific size and grade of fastener.

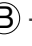
STRENGTH								
	Max Torque		Max Torque		Max Torque		Max Torque	
Dia / Pitch	lb.ft	Nm	lb.ft	Nm	lb.ft	Nm	lb.ft	Nm
M5 x 0.80	2	3	4.5	6	6.5	9	7.5	10
M6 x 1.00	4	5.5	7.5	10	11	15	13	18
M8 x 1.25	10	13	18	25	26	35	33	45
M10 x 1.25	20	27	39	53	57	78	66	90
M10 x 1.50	18	25	37	50	55	73	63	86
M12 x 1.75	33	45	63	85	97	130	111	150
M14 x 2.00	55	75	103	140	151	205	177	240
M16 x 2.00	85	115	159	215	232	315	273	370



PRE-INSTALLATION

Note: Before proceeding please read the installation precautions. The letters on drawings relate to text, numbers circled relate to the parts list in this manual.

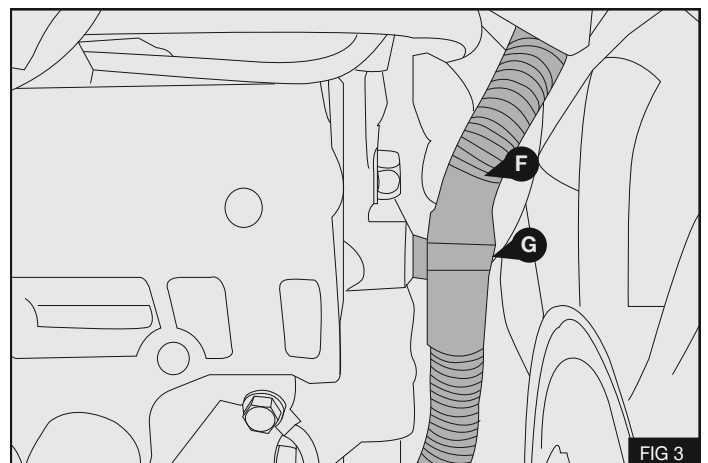
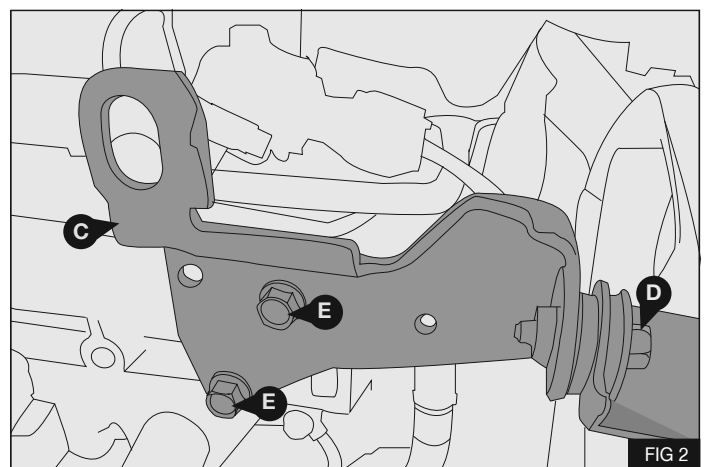
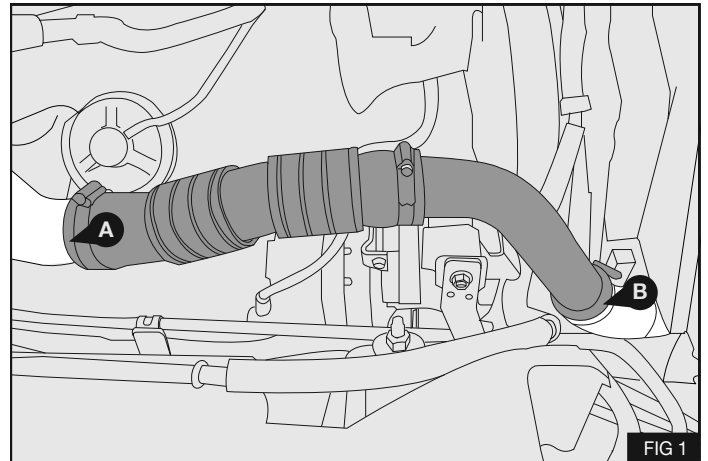
1. Remove the section of intercooler hose between  and  - Fig 1
2. Remove and discard the engine lifting / fan cowl support bracket  – Fig 2
3. Retain the M8 bolt , discard 2x M10 bolts  – Fig 2
4. Remove the wiring loom  from the securing point at the front  of the engine – Fig 3

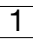

MOUNT BRACKET INSTALLATION

1. Install the mount bracket  to the engine using the supplied M10x50 bolts  – Fig 4
2. Torque bolts  to 63 Nm / 46 lb-ft using a calibrated torque wrench – Fig 4

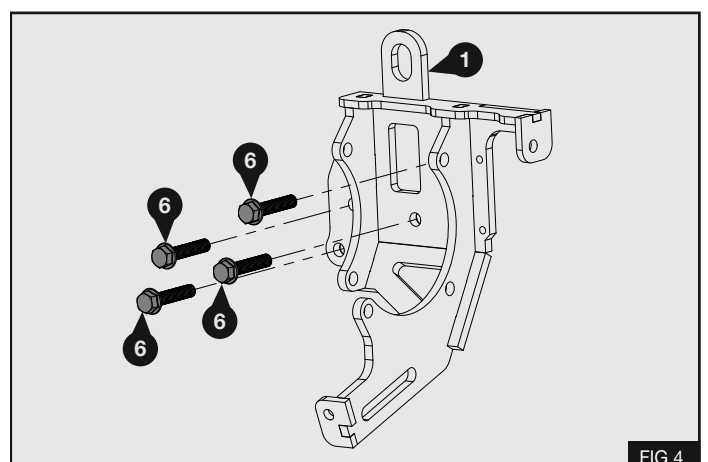

- Secure the wiring loom (F) to the 2x 6mm holes in the mount bracket (1) using the supplied cable ties (13) – Fig 5
- Secure fan cowl the mount bracket (1) using the original M8 bolt (D) into the supplied M8 nut (12) – Fig 5

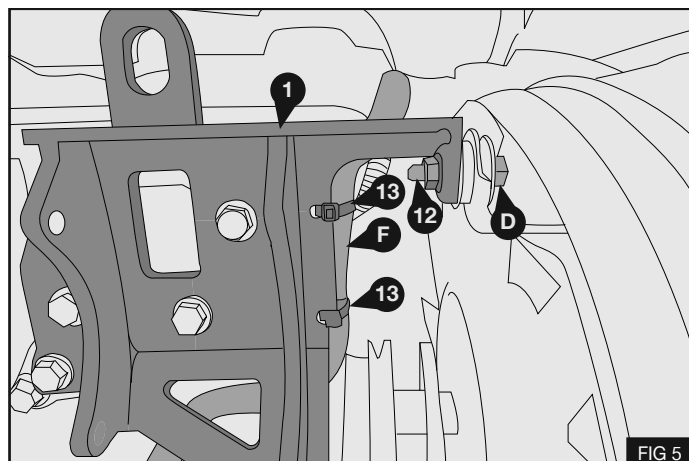

- Assemble the idle pulley (2) to the mount bracket (1) using bolts (10) and (11) spacer (3) washer (9) and adjuster block (4) as shown opposite – Fig 6

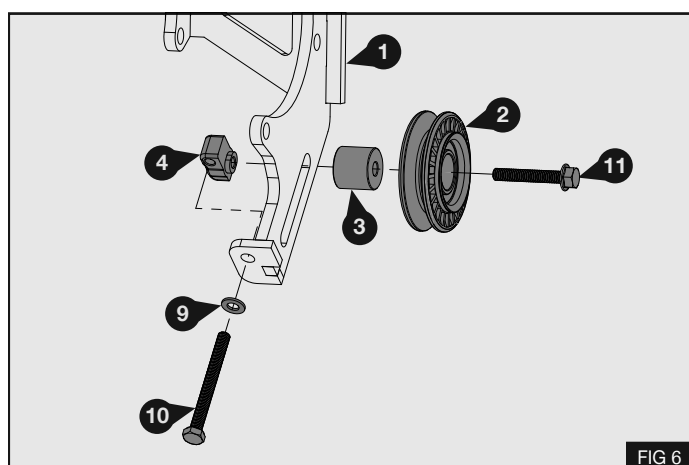

Note: Insert the bolts (7) in the direction shown opposite – Fig 7

- Install the compressor to the mount bracket (1) using the 5x M10x35 bolts (7) with nuts (8) – Fig 7
- Torque bolts (7) to 63 Nm / 46 lb-ft using a calibrated torque wrench – Fig 7

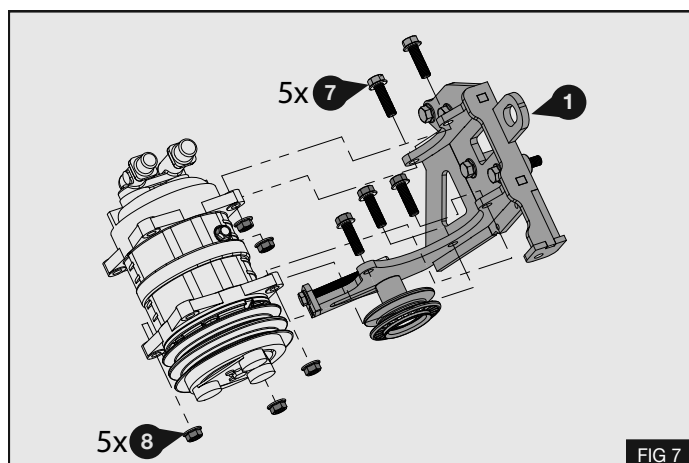

DRIVE BELT INSTALLATION

- Feed the supplied drive belt (5) over the viscous fan and install the drive belt to the pulleys as shown opposite – Fig 8

A – Crankshaft Pulley
 B – Idle Pulley
 C – Compressor
 D – Fan Pulley

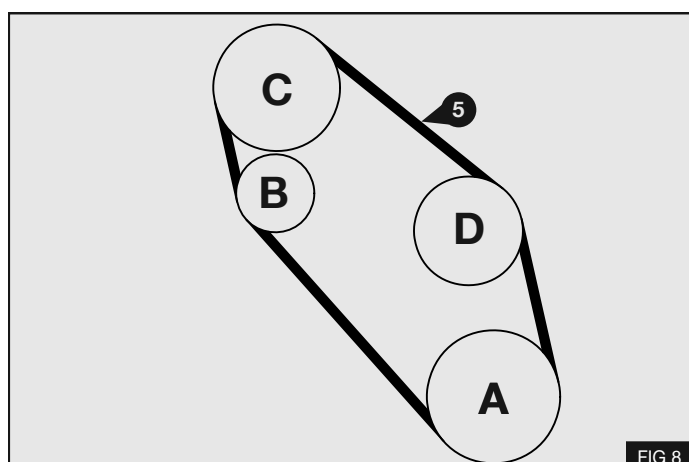

2. Insert the drive belt (5) in the rear groove of the compressor clutch as shown opposite – Fig 9

Belt Tension Table	
Belt Age	Belt Tension
New Belt	55 - 65 kg
Used Belt/ Re-tension	40 - 45 kg

3. Tension the drive belt using the adjuster bolt (10). When the correct tension (new belt level) has been achieved (see table). Torque the tensioner lock bolt (11) to 29Nm / 22lb-ft. using a calibrated torque wrench – Fig 10

Note: A new drive belt must be tensioned to the “new belt level” in order to mesh correctly into the pulley grooves. The belt tension will then fall after a running in period.

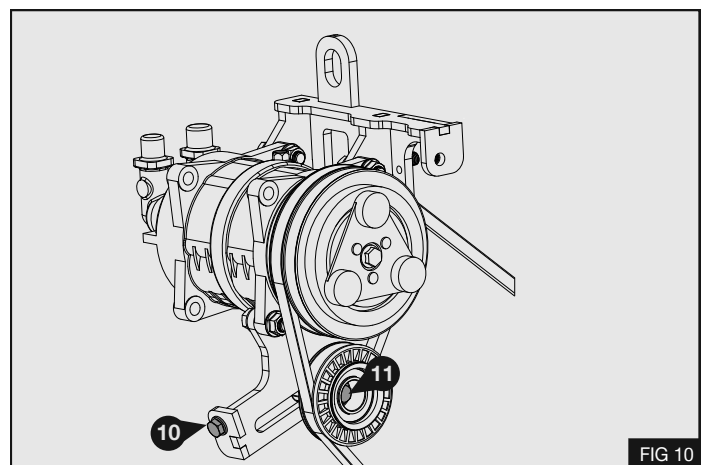
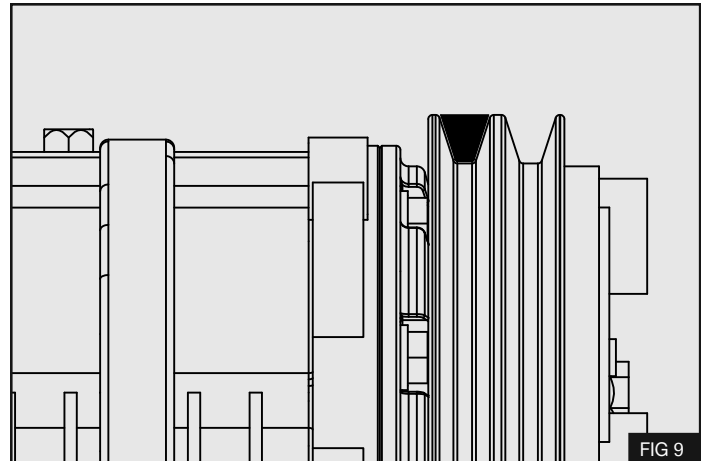

FINISH

1. Refit the intercooler hose
2. Check clearance between belt (5) and wiring loom (F) - Fig 5
3. Run the engine with the compressor clutch engaged for five minutes, Check all components.
4. Re-check the belt tension adjust if required.
5. Install the supplied belt label in the engine bay.